

Z-FLEX®

Available in sizes
up to 24"
single and double wall

SPECIAL GAS VENT FOR
CATEGORY I, II, III, IV HEATING EQUIPMENT

Z-Vent®

Designed for use with
boilers, high efficiency
furnaces, pool heaters,
unit heaters and tankless
water heaters.

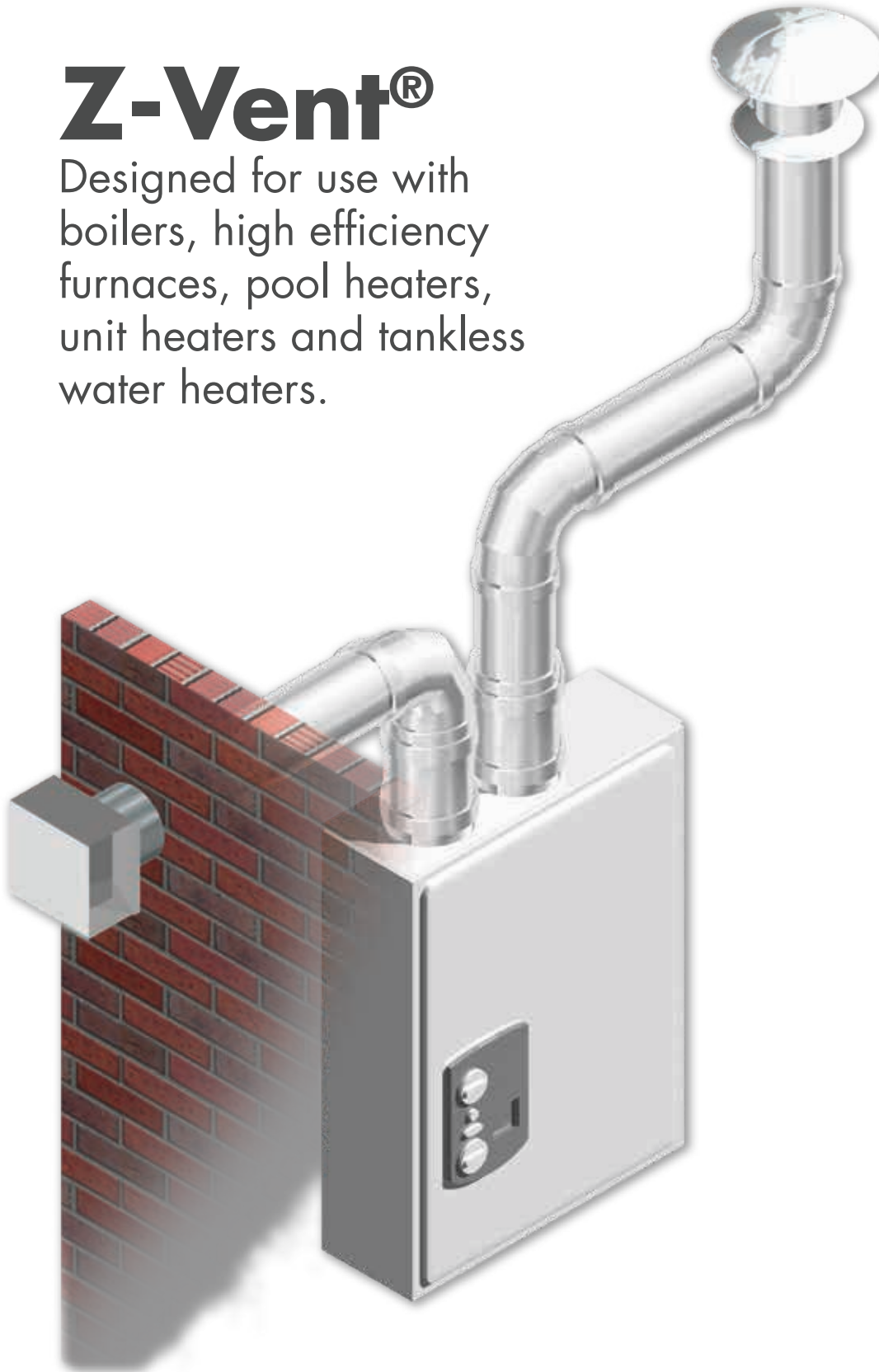

UL US LISTED

Z-Vent[®] is manufactured using UNS S44735 (i.e. AL29-4C^{®*}) superferritic stainless steel** with unmatched corrosion resistance for use with condensing furnaces and boilers. Z-Vent[®] was developed in the early 1980's and has thousands of field installations to date. Z-Vent[®] is manufactured utilizing a fail-safe gasket connection. No sealant required. The lengths of pipe may be cut on non-expanded end using aviation snips or a hacksaw (24tpi). The cut end must be filed or sanded smooth before joining.



45° DEGREE ELBOW



Catalogue No	A	B	C
2SVEEWC(F_)0345	3"	8.25"	5.5"
2SVEEWC(F_)0445	4"	7"	5.7"

HORIZONTAL DRAINPIPE

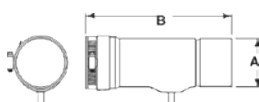

Catalogue No	A	B
2SVEDWC(F_)03	3"	8.5"
2SVEDWC(F_)04	4"	10.5"

90° DEGREE ELBOW

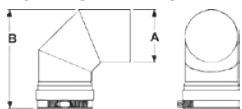

Catalogue No	A	B	C
2SVEEWC(F_)0390	3"	8.25"	5.5"
2SVEEWC(F_)0490	4"	7"	5.7"

GAS VENT PIPE



Catalogue No	A
2SVEPWC(F_)03	3"
2SVEPWC(F_)04	4"

WALL TERMINATION

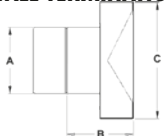

Catalogue No	A	B	C
2SVS(TB, RTX)03	3"	4"	5"
2SVS(TB, RTX)04	4"	4"	6"

VERTICAL DRAIN/TEE

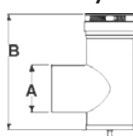

Catalogue No	A	B
2SVEVWC(F_)03	3"	7.5"
2SVEVWC(F_)04	4"	7.5"

Features:

- Gasketed connections
- Fusion welded pipe seams
- Metallic special gas vent that can be cut to length on site
- 1" clearance to combustibles

Benefits:

- No sealant required. Immediate start up, no call backs
- Provides an air-tight seam, smooth finish and a better fit
- Being able to cut the product in the field will save you time and money. Pipe available from 6" through 10' lengths
- Can be installed with minimum clearance to combustibles

Appliance connectors available for most equipment. Please refer to Z-Vent Appliance Adaptors

*AL-294C[®] is a registered trademark of ATI Properties, Inc.

The information provided within is for informational purposes only. We have made every effort to ensure the accuracy of the provided information and assume no responsibility for any loss or damage due to errors or omissions or to the use or misuse of any information supplied. It is impossible to test all products under all conditions to which they might be subjected in the field. It is therefore the buyer and/or end users' responsibility to test all products under the conditions that duplicate the service conditions prior to installation. All improvements, all specifications are subject to change without prior notice. It is the buyer and/or end users' responsibility to review our complete Terms and Conditions of Sale located on our web sites at: www.novaflex.com | www.z-flex.com | www.flexmaster.com.

Typical Installations

Vertical Detail

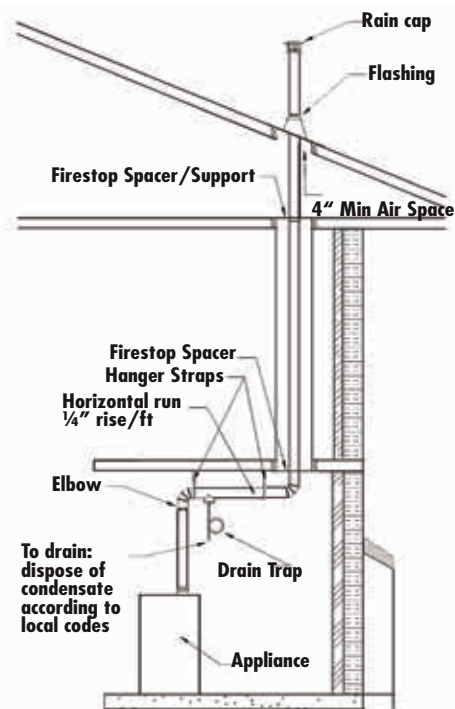

Side Wall Detail

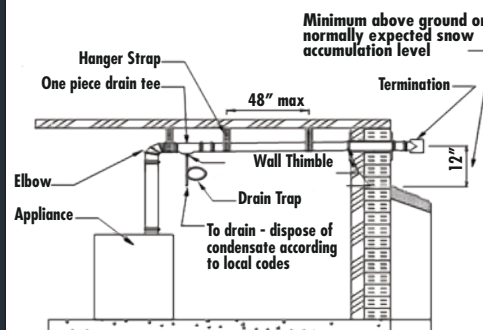

Joint Detail

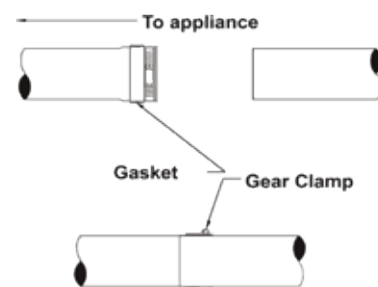

*All drawings are for illustrative purposes only. Please refer to guide for specific U.L. installation instructions. Always defer to local building codes.
** AL29-4C[®] is a registered trademark of Allegheny Ludlum Steel Corporation

U.S.A.

20 Commerce Park North, Bedford, NH 03110-6911
Tel: 603.669.5136 800.654.5600 Fax: 888.889.3539

CANADA

452 Attwell Drive, Etobicoke, ON M9W 5C3
Tel: 416.679.0045 Fax: 416.679.0051



ver 11.2020

Email: sales@z-flex.com
Web site: www.z-flex.com